

LIGHT CONDUCTORS

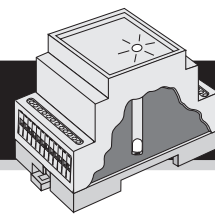

Ø 3mm light conductors for SMD or Leaded Led's for transporting the light from the PCB to the front of the enclosure. - 5 different types can be combined into 20 different lengths from 11,8 mm to 51 mm including special length to fit most of Bernic's enclosures.

Foot 4.5 mm SMD

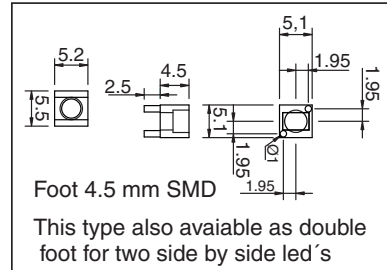
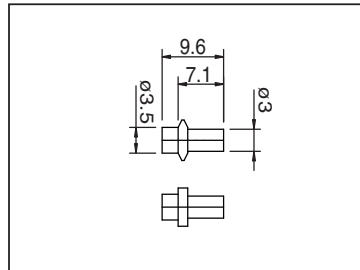
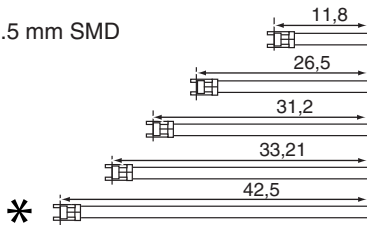

Foot 9.0 mm SMD

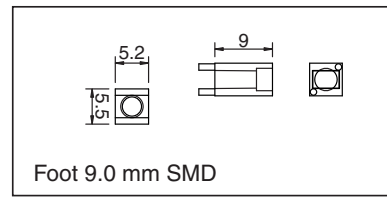
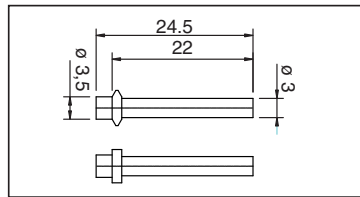
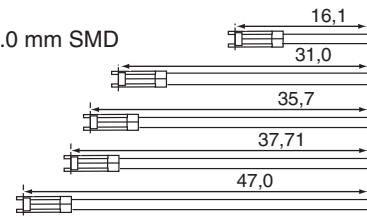

Foot 11.0 mm Leaded

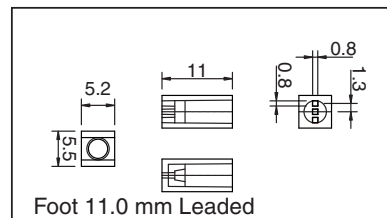
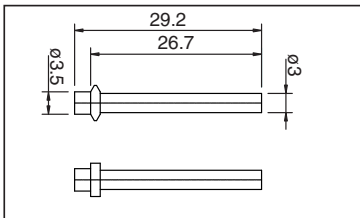
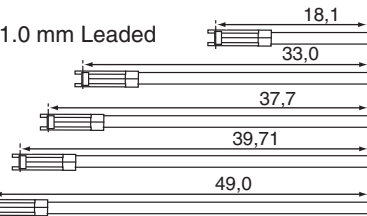

Foot 13.5 mm SMD

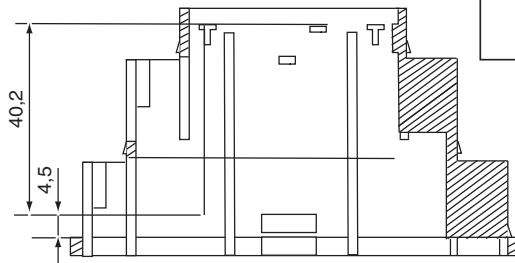
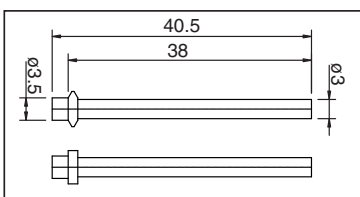
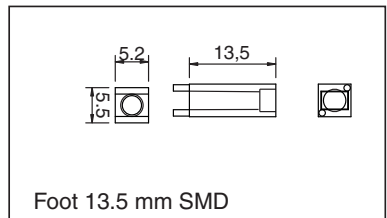
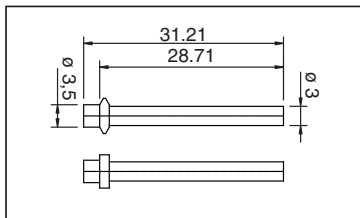
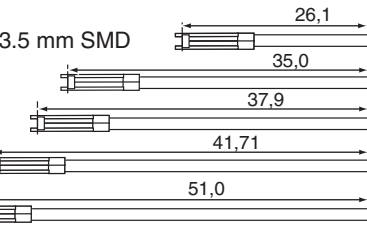

* For Din Rail Enclosures from base PCB to front

Total length	4,5 mm foot	11,6	26,5	31,2	33,21	42,5 *
Order Code:	SMD	p/n 4972301250	p/n 4972301251	p/n 4972301252	p/n 4972301253	p/n 4972301254
Total length	9,0 mm foot	16,1	31,0	35,7	37,71	47,0
Order Code	SMD	p/n 4972301255	p/n 4972301256	p/n 4972301257	p/n 4972301258	p/n 4972301259
Total length	11,0 mm foot	18,1	33,0	37,7	39,71	49,0
Order Code	LEADED	p/n 4972301260	p/n 4972301261	p/n 497301262	p/n 4972301263	p/n 4972301264
Total length	13,5 mm foot	20,6	35,5	40,2	42,21	51,5
Order Code	SMD	p/n 4972301265	p/n 4972301266	p/n 4972301267	p/n 4972301268	p/n 4972301269

● All measurements are in mm.